

# PRESS BRAKE TOOLS

## VERKTYG FÖR KANTPRESSAR



# UPPER TOOLS

## ÖVERVERKTYG

### OV 31

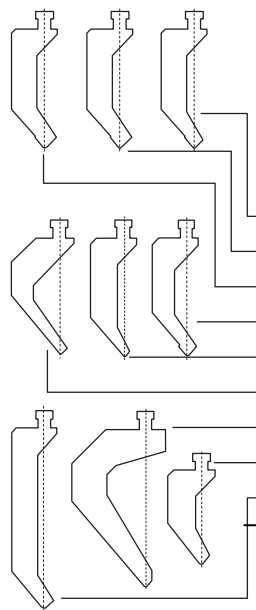

Part. No Art. nr	Measure Mått											Load Belastning  tons/m ton/m
	R	A	C	D	E	F	G	H	k	V	M	
	mm	mm	mm	mm	mm	mm	mm	mm	°	°	mm	
49252	1	50	15	7	59	28	10	125	30	80	14	Max 75
49253	3	50	15	7	56	30	11	125	30	80	17	Max 100
52323	6	50	15	7	56	31	10	125	30	80	17	Max 100
52324	1	50	15	15	38	41	10	125	30	80	14	Max 50
52325	1	45	15	7	70	21	5,5	125	30	80	8	Max 35
52326	1	65	15	30	16	52	7	125	35	80	10	Max 15
52328	1	115	25	48	36	97	9	200	30	80	13	Max 35
52329	1	50	15	6	38	26	10	100	30	80	14	Max 100
52330	3	50	15	6	133	29	11	200	30	80	17	Max 100
91636	1	50	15	6	135	127	11	200	30	80	17	Max 100

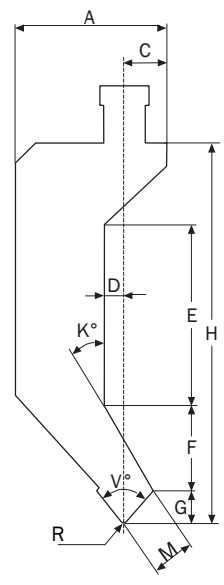

### OV 32/33

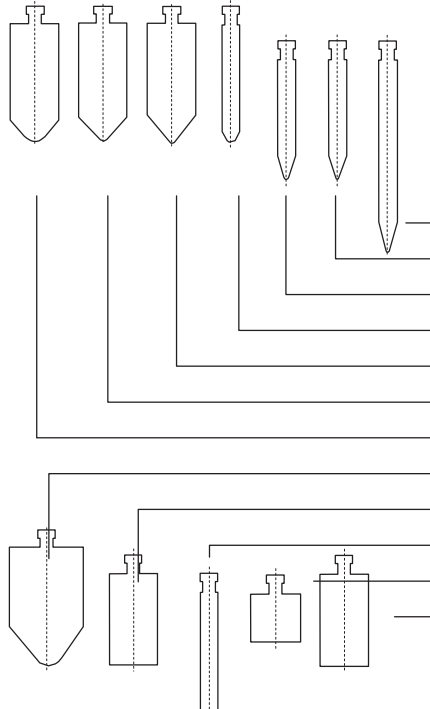

Part. No Art. nr	Measure Mått				Load Belastning  tons/m ton/m
	R	A	H	V	
	mm	mm	mm	°	
52339	1	16	200	28	Max 75
49256	1	16	125	28	Max 75
49728	3	16	125	28	Max 100
52338	6	16	125	28	Max 100
49254	6	50	125	80	Max 350
49255	12	50	125	80	Max 350
52331	20	50	125	80	Max 350
52332	25	80	125	80	Max 600
52333	-	50	125	-	Max 350
52334	-	16	125	-	Max 100
52335	-	50	50	-	Max 350
52336	-	50	100	-	Max 350

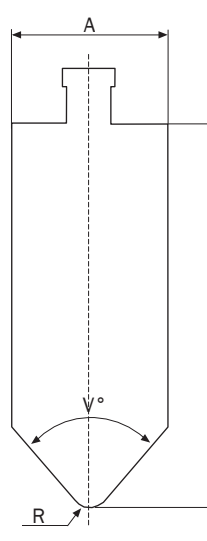

# RADIUS TOOL VERKTYGSSPETS

For Max 350 tons/m / För max 350 ton/m

Part. No Art.nr	Measure Mått		
	R	B	H
	mm	mm	mm
65091	3	45	40
52451	6	45	40
92493	8	45	40
92449	10	45	40
52452	12	45	40
69291	15	45	40
92322	18	45	40
52453	20	45	40
52454	25	50	40
52455	30	60	40
52456	35	70	40
52457	40	80	40
52458	45	90	60
52459	50	100	65
52460	60	120	90
52461	70	140	60
70882	74	145	60
92496	75	125	50
92486	80	125	50

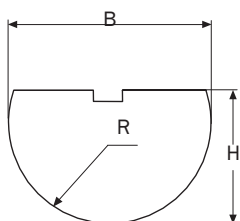
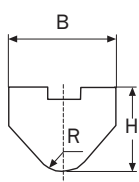

# PUNCH HOLDER VERKTYGSHÅLLARE

For Max 350 tons/m / För max 350 ton/m

Part. No Art.nr	Measure Mått			Load Belastning
	A	D	H	
	mm	mm	mm	tons/m ton/m
52450	50	110		Max 350
92321	50	150		Max 350

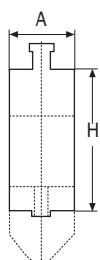

# RADIUS TOOL VERTYGSSPETS

For Max 200 tons/m / För max 200 ton/m

Part. No Art.nr	Type typ	Measure Mått		
		R	B	H
		mm	mm	mm
92331	A	1	45	45
91908	A	3	45	45
66511	A	4	45	45
66512	A	5	45	45
52341	A	6	45	45
55153	A	7,5	45	45
53950	A	8	45	45
55154	A	10	45	45
52342	A	12	45	45
55155	A	1/2"	45	45
55604	A	15	45	45
59266	A	16	45	45
66397	A	18	45	45
55156	A	19	45	45
52343	A	20	45	45
69136	A	22	45	45
68540	A	25	45	45
52344	B	25	35	
92349	B	1"	35	
91428	B	26	35	
69773	B	28	45	
52345	B	30	45	
56220	B	32	45	
52346	B	35	60	
52347	B	40	70	
52348	B	45	80	
52349	B	50	93	
52350	B	60	115	
52351	B	70	135	

TYP A

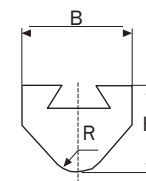

TYP B

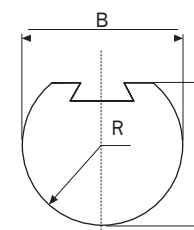

# PUNCH HOLDER VERKTYGSHÅLLARE

For Max 200 tons/m / För max 200 ton/m

Part. No Art.nr	Measure Mått			Load Belastning
	A	D	H	
	mm	mm	mm	tons/m ton/m
52340	50	100		Max 200
55926	50	150		Max 200
66506	50	8	125	Max 100

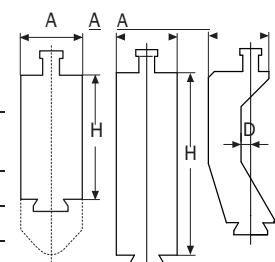

# UPPER TOOLS UMVR

## ÖVERVERKTYG UMV-R

# HEMMING TOOLS

## OMSLAGSVERKTYG

Radius nose UMV-R / Verktvgsspetsar UMV-R

L = 835/ L = 415

Part. No Art.nr	Measure Mått		
	R	B	H
	mm	mm	mm
79049-03H	28	80	84
79050-03H	37	74	70
76133-61H	45	90	60
79051-03H	46	92	100
79052-03H	53	106	100
76133-65H	75	135	60
76133-62H	85	154	60
76133-67H	102	184	80
76133-69H	112	202	80
76133-63H	120	216	80
76133-71H	150	120	60
76133-64H	160	290	100

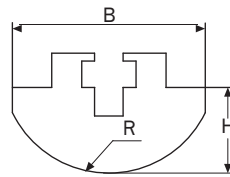

Part. No Art.nr	Measure Mått				Load Belastning  tons/m ton/m
	a	A	H	V	
	Die mm Dyna mm	Width mm Bredd mm	Height mm Höjd mm	Angle mm Vinkel mm	
20.264-SP	6	60	105>90	35	60
20.303-SP	8	60	110>95	30	80
20.231-SP	10	60	135>120	26	100
20.305-SP	12	60	140>125	26	100

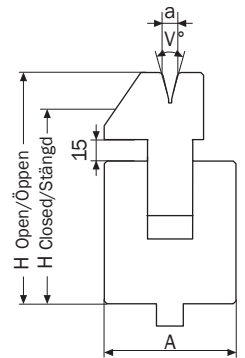

Holder UMV 28-UMV-R / Hållare UMV 28-UMV-R

L = 500

Part. No Art.nr	Measure Mått			Load Belastning  tons/m ton/m
	A	D	H	
79007-62	70		65	350
79053-02		400		350

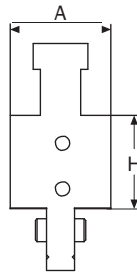



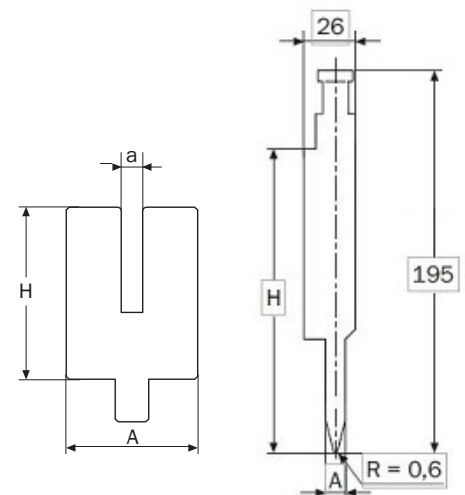

Part. No Art.nr	Measure Mått				Load Belastning  tons/m ton/m
	a	A	H	V	
	Die mm Dyna mm	Width mm Bredd mm	Height mm Höjd mm	Angle mm Vinkel mm	
15.902US		8	155	24°	80
25.992	8,2	57	100		50
15.904US		10	155	24°	80
25.994	10,2	57	100		50
15.905US		12	155	24°	80
25.995	12,2	57	100		50

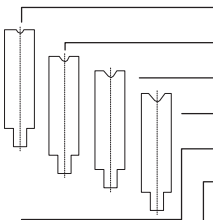
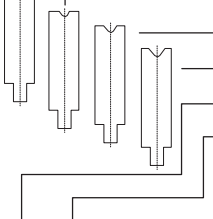
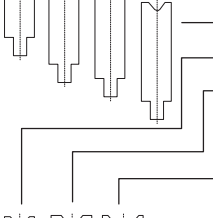
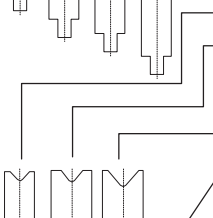
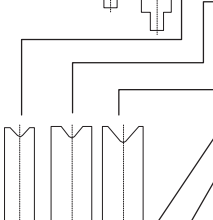
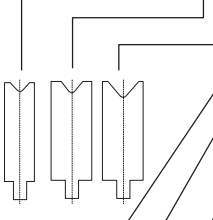
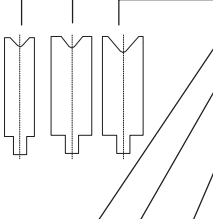
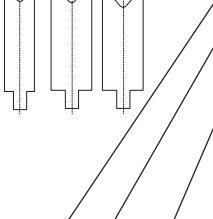
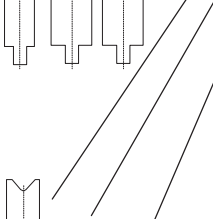
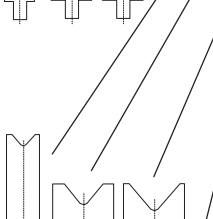
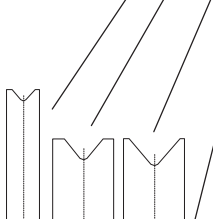
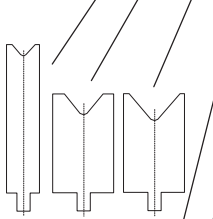
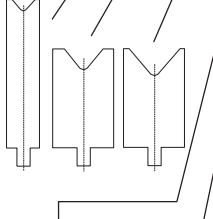
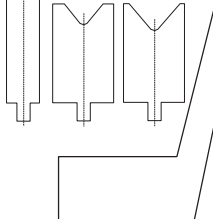
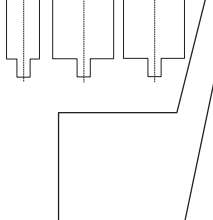
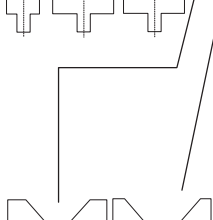
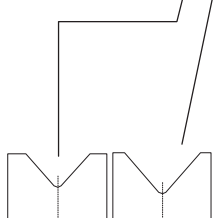
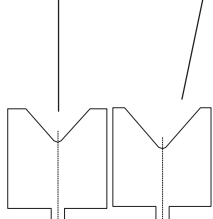
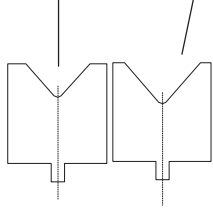
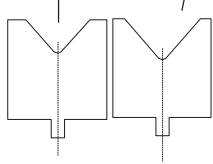
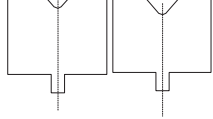

# DIES

## UNDERVERKTYG

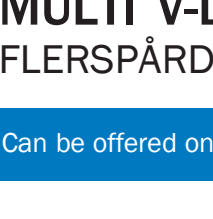
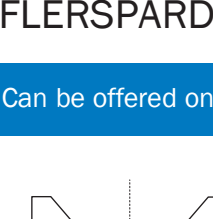
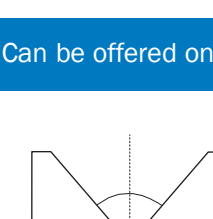
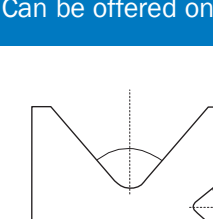
	Part. No Art.nr	Measure Mått				Load Belastning
		a	A	H	V	
		Die mm Dyna mm	Width mm Bredd mm	Height mm Höjd mm	Angle mm Vinkel mm	
	52365	8	30	100	80	125
	52366	10	30	100	80	125
	52367	12,5	30	100	80	100
	52368	16	30	100	80	80
	52369	20	30	100	80	70
	52370	25	40	100	80	80
	52371	32	40	100	80	70
	56545	25	32	150	80	60
	52372	40	60	100	80	125
	52373	50	60	100	80	100
	52374	64	100	100	80	190
	52375	80	100	100	80	170
	52376	8	30	100	28	70
	52377	10	30	100	28	50
	52378	12,5	30	100	28	30
	52379	16	30	100	28	25
	52380	20	30	100	28	20
	52381	25	40	100	28	25
	52382	32	40	100	28	20
	56550	16	30	150	28	25
	56540	8	16	150	80	55
	56541	10	18	150	80	55
	56542	12,5	20	150	80	50
	56543	16	24	150	80	50
	56544	20	25	150	80	50
	56546	6	12	150	28	15
	56547	8	16	150	28	20
	56548	10	20	150	28	23
	56549	12,5	25	150	28	25

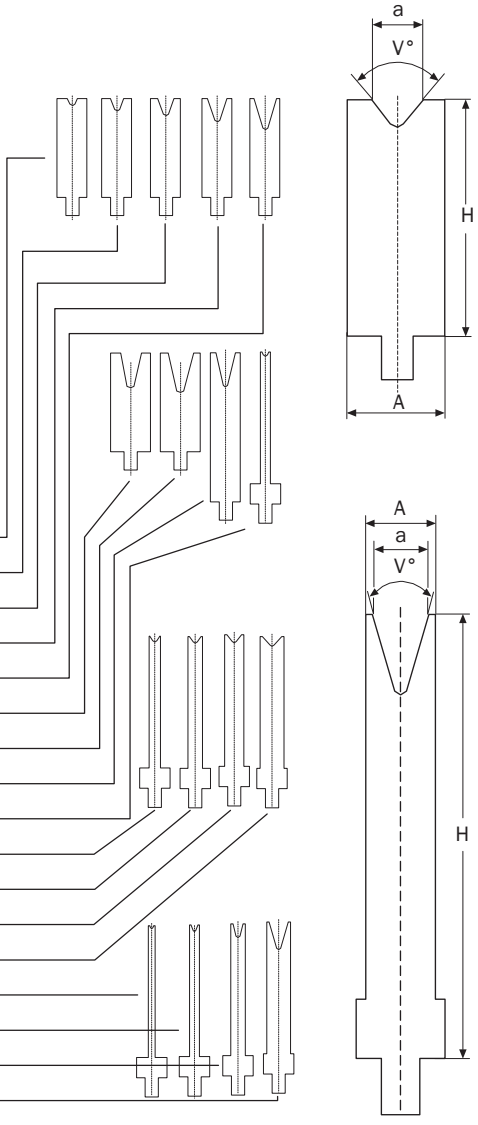

## MULTI V-DIES FLERSPÅRDYNOR

Can be offered on request/Offereras på begäran

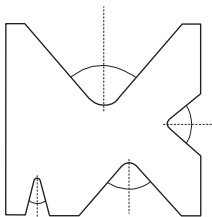

## VDT VDT

Can be offered on request/Offereras på begäran

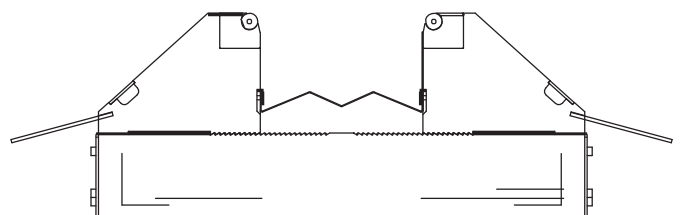

# DIES

## UNDERVERKTYG

L = 500/ L = 550 mm

Part. No Art.nr	Measure Mått				Load Belastning
	a	A	H	V	
	Die mm Dyna mm	Width mm Bredd mm	Height mm Höjd mm	Angle mm Vinkel mm	tons/m ton/m
25.100	4	8	100	86	100
25.201	6	20	100	84	100
25.202	8	20	100	84	100
25.203	10	20	100	84	100
25.204	12	25	100	84	100
25.205	16	30	100	84	100
25.206	20	30	100	84	100
25.207	24	35	100	80	100
25.208	30	45	100	80	100
25.209	40	55	100	80	100
25.210	50	65	100	80	100
25.111	60	75	100	80	100
25.112	70	85	100	80	100
25.113	80	100	100	80	100
25.114	90	110	120	80	100
25.115	100	120	120	80	100
25.116	120	145	120	60	100
25.621	6	20	150	84	100
25.622	8	20	150	84	100
25.623	10	20	150	84	100
25.624	12	25	150	84	100
25.625	16	30	150	84	100
25.626	20	30	150	84	100
25.627	24	35	150	80	100
25.628	30	45	150	80	100
25.629	40	55	150	80	100
25.630	50	65	150	80	100
25.400	4	15/20	100	30	20
25.401	6	20	100	30	40
25.402	8	20	100	30	40
25.403	10	20	100	30	40
25.404	12	25	100	30	40
25.405	16	30	100	30	50
25.406	20	35	100	30	60
25.407	24	40	100	30	65
25.408	30	55	100	30	90
25.409	40	60	100	30	90
25.901	6	20	150	30	30
25.902	8	20	150	30	40
25.903	10	20	150	30	40
25.904	12	25	150	30	40
25.905	16	30	150	30	50
25.906	20	35	150	30	60
25.907	24	40	150	30	65
25.908	30	55	150	30	90
25.909	40	60	150	30	90

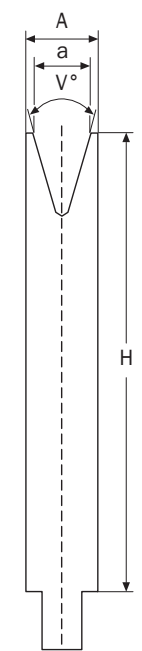
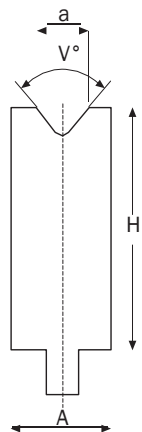

# JOGGLE (Z) TOOL HOLDER AND INSERTS

## Z-VERKTYG HÅLLARE OCH INSATSER

L=835/L=415

Part. No Art.nr	Measure Mått		Load Belastning
	A	H	
	Width mm Bredd mm	Height mm Höjd mm	tons/m ton/m
79057	46	89/113	100
79058	46	64/88	100

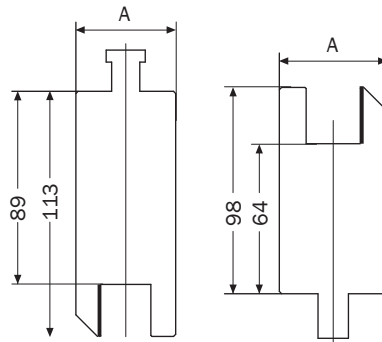

Part. No Art.nr	Measure Mått	
	Z	V
	mm	Angle mm Vinkel mm
40.510	1.0	160°
40.515	1.5	160°
40.520	2.0	150°
40.525	2.5	150°

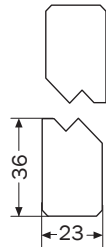

Part. No Art.nr	Measure Mått	
	Z	V
	mm	Angle mm Vinkel mm
40.590	9.0	90°
40.610	10.0	90°
40.611	11.0	90°
40.612	12.0	90°
40.613	13.0	90°
40.614	14.0	90°
40.615	15.0	90°

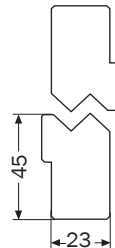

Part. No Art.nr	Measure Mått	
	Z	V
	mm	Angle mm Vinkel mm
40.511	1.0	90°
40.516	1.5	90°
40.521	2.0	90°
40.526	2.5	90°
40.530	3.0	90°
40.535	3.5	90°
40.540	4.0	90°
40.545	4.5	90°
40.550	5.0	90°
40.555	5.5	90°
40.560	6.0	90°
40.565	6.5	90°
40.570	7.0	90°
40.575	7.5	90°
40.580	8.0	90°

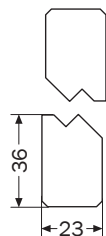

# HOLDERS FOR INTERCHANGABLE PLASTIC INSERTS

## HÅLLARE MED UTBYTBARA PLASTINSATSER

L=835/L=415

Part. No Art.nr	Measure Mått				Load Belastning
	a	A	H	V	
	Die mm Dyna mm	Width mm Bredd mm	Height Höjd mm	Angle mm Vinkel mm	tons/m ton/m
22.005		35	95		20
32.306	6	20	24	30	20
32.308	8	20	24	30	20
32.310	10	20	24	30	20
32.406	6	20	24	45	20
32.408	8	20	24	45	20
32.410	10	20	24	45	20
32.412	12	20	24	45	20
32.606	6	20	24	60	20
32.608	8	20	24	60	20
32.610	10	20	24	60	20
32.612	12	20	24	60	20
32.616	16	20	24	60	20
32.806	6	20	24	88	20
32.808	8	20	24	88	20
32.810	10	20	24	88	20
32.812	12	20	24	88	20
32.816	16	20	24	88	20

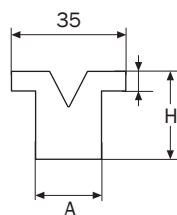
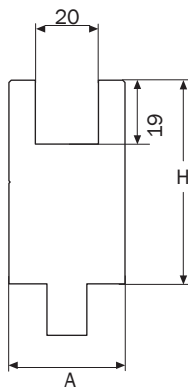

## URSVIKEN

Ursviken Technology AB

Mekanvägen 71  
SE-932 82 URSVIKEN  
Sweden

Tel +46 (0)910 - 516 00  
Fax +46 (0)910 - 516 80

info@ursviken.com  
www.ursviken.com

